



Atlas Copco



GTG40 Angle Turbine Grinder

Feel the power. Boost the performance.



Highly efficient turbine motor

Overspeed shut-off device

Precise speed governor

Reduced risk of vibration related injuries

Increased accessibility

Adjustable wheel guard

MORE EFFECTIVE

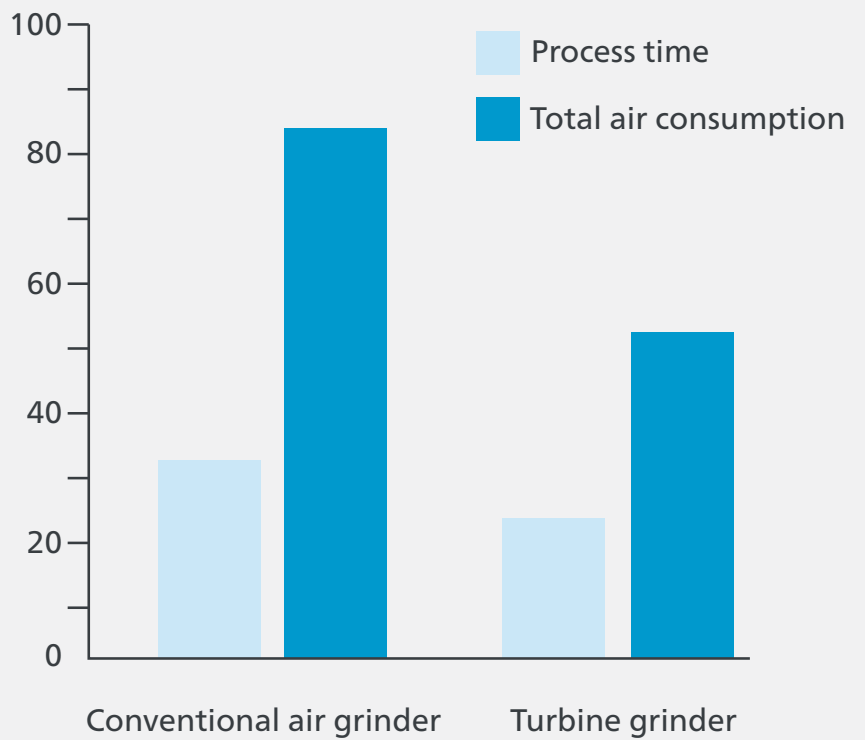

The turbine motor is more efficient than a conventional grinder motor. Therefore it takes less time to do the same job. Also the total air consumption will be a lot less for a specific job.

Model	Max free speed (r/min)	Max output (Kw)	Max wheel/ pad dia (mm)	Spindle thread	Spindle length (mm)	Weight (kg)	Height (mm)	Height over spindle (mm)	Air consumption at max output (l/s)	Air consumption at free speed (l/s)	Rec. hose size (mm)	Air inlet thread BSP	Auto balancer	Ordering No.
Grinder														
GTG40 F085-18	8500	4.5	180			3.8	128	99	60	20	16	1/2"	Yes	8423 2900 10
GTG40 F066-23	6600	4.5	230			4.0	128	99	60	20	16	1/2"	Yes	8423 2910 10
Sander														
GTG40 S060	6000	4.5	140	5/8-11 UNC	22.3	3.6	132	122	60	20	16	1/2"	Yes	8423 2930 00
Cup wheel & wire brush														
GTG40 S060-C15	6000	4.5	150	5/8-11 UNC	22.3	4.3	160	123	60	20	16	1/2"	Yes	8423 2930 10

Tool accessories	Ordering No.
Add on spot suction Ø 180-230 mm	3780 4032 12
Hand shield	4175 0165 90
Vibration damped handle	4150 1521 80
Adapter for positioning support handle 120/135°	4175 0164 90
Heavy duty backing pad for sanding Ø 180 mm (7")	4170 1192 90
Friction plate complete	4175 0186 90

Air line accessories	Ordering No.
MultiFlex swivel, 1/2" BSP	8202 1350 60
Productivity kit, MAXI-FRL-1-BSP, with claw coupling, 5m hose	8202 0850 05
FRL Stand	
FRL-STAND-MAXI-BSP	9090 3030 14
Hose kit 1/2" inch Tool Inlet BSP (5m)	8202 1181 82



How to assemble a dust extraction kit



MultiFlex Swivel Connector: An ergonomic solution



Increase productivity with Atlas Copco's air preparation units – FRL range

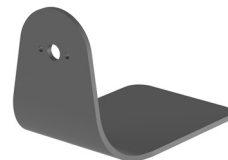

Hand shield

Atlas Copco

Atlas Copco AB
 (publ) SE-105 23 Stockholm, Sweden
 Phone: +46 8 743 80 00
 Reg. no: 556014-2720
 atlascopco.com